

NOVADRIVE NC/NO

ACTUATOR



Electro-thermal actuators in the operating mode normally open and normally closed for heating circuit manifolds and radiator valves.

DESCRIPTION

NovaDrive NC/NO actuators in the new, attractive appearance used in conjunction with room thermostats, time switches and building automation systems offer an efficient means of controlling temperatures in heating and cooling systems to suit individual requirements.

Thanks to the operating mode NO (normally open) and NC (normally closed) as well as the quick-locking, large surface bayonet connection, the actuators can be used in a wide range of applications in all HVAC systems.

These actuators can help eliminate energy wastage in heating as well as in cooling and offer the ideal solution for energy control in buildings with irregular occupancy levels. Typical installations include apartments, offices, schools, hotels etc. The standard valve position indicators integrated into the actuators control the system functions during the assembly, commissioning and monitoring stages.

INSTALLATION POSITION

Any.

ADVANTAGES

- Operating mode NO normally open and NC normally closed
- Valve position visually indicated and tangible
- Bayonet connection audibly engaged with click
- Attractive appearance
- Low power input
- Silent operation
- Available to fit most valve bodies
- Connection cable, pluggable

OPERATION

An electrical resistance heats an expansion element. Any deviation from the nominal room temperature value causes the actuator to transmit an appropriate stroke movement to the valve.

The thermostat and actuator operate according to the «ON / OFF» principle. The variable, rhythmic opening and closing, depending on the heat demand, also produces an almost continuous control characteristic.

In the without current state, the valve is open with the type NO and closed with the type NC.

BUILDING CATEGORIES

For installations in the heating and cooling area:

- Apartment blocks, housing estates, multiple dwelling units
- Residential care facilities, hospitals
- Administration and service buildings
- Hotels and restaurants, industrial kitchens
- School buildings and sports facilities
- Commercial and industrial buildings

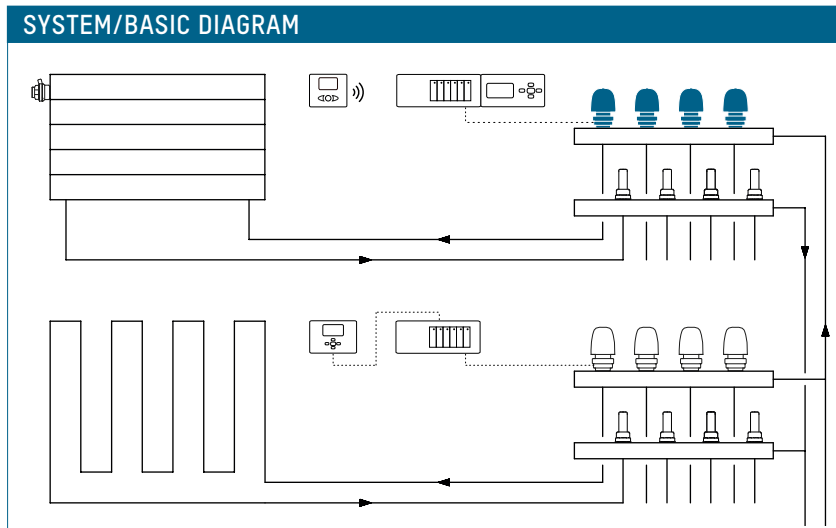

NOVADRIVE NC/NO | ACTUATOR

SPECIFICATION TEXT

See www.taconova.com

TECHNICAL DATA

General

- Versions:
 - Normally closed NC
 - Normally open NO
- Ambient temperature: 0 ... 50° C
- Opening/closing time: approx. 3 min.
- Nominal stroke: 4 mm
- Nominal closing force 90 N
- Protection mode IP 40
- Protection class II

Electrical specifications

- Rated voltage (AC or DC):
24 V or 230 V
- Permissible voltage deviation: ±10%
- Operating efficiency: 1.6 W
- Inrush current:
 - 24V: 0.2 A for max. 1 min;
 - 230V: 0.6 A for max. 100 ms
- Recommended fuse protection:
0.35 A time delay, according to
DIN 41662
- Connecting cable length 1 m

APPROVALS / CERTIFICATES

- CE conformity symbol
- The technical data conforms with
the respective EN standards

ACCESSORIES

Various room thermostats and
junction modules for wired and
wireless applications
(see separate data sheets).

TYPE OVERVIEW

NovaDrive NC | Electro-Thermal Actuator, Function NC (Normally Closed)

Order no. 230 V	Connection	Suitable for valves of make*
257.2854.000	M30 × 1,0	Beulco (old type, approx. until march 2005)
257.2855.000	M30 × 1,5	TacoSys/Heimeier/Strawa/Empur Messing/Oventrop/Delphistherm/ Emmeti/Schlösser/Beulco/AC-FIX/ Stramax/Roth/IVR
257.2858.000	M28 × 1,5	Herz (RV 57)
257.2862.000	M30 × 1,5	MNG/Cazzaniga/SBK/Empur-Edelstahl/ SKV-Ventil frontal
257.2864.000	Adapter	Giacomini

Order no. 24 V	Connection	Suitable for valves of make*
257.1855.000	M30 × 1,5	TacoSys/Heimeier/Strawa/Empur Messing/Oventrop/Delphistherm/ Emmeti/Schlösser/Beulco/AC-FIX/ Stramax/Roth/IVR

NovaDrive NO | Electro-Thermal Actuator, Function NC (Normally Open)

Order no. 230 V	Connection	Suitable for valves of make*
257.2554.000 **	M30 × 1,0	Beulco (old type, approx. until march 2005)
257.2555.000	M30 × 1,5	TacoSys/Heimeier/Strawa/Empur Messing/Oventrop/Delphistherm/ Emmeti/Schlösser/Beulco/AC-FIX/ Stramax/Roth/IVR
257.2562.000	M30 × 1,5	MNG/Cazzaniga/SBK/Empur-Edelstahl/ SKV-Ventil frontal

* Further specific customer designs for all types of valve bodies on request.
If you are unsure about valve adjustment, please contact customer service.

** As long as available

NOVADRIVE NC/NO | ACTUATOR

ECO-TIP

SAVE ENERGY AND MONEY!

To avoid unnecessary hours of operation, the actuator should be switched off via the room thermostat out of the heating period.

DIMENSIONAL DRAWING

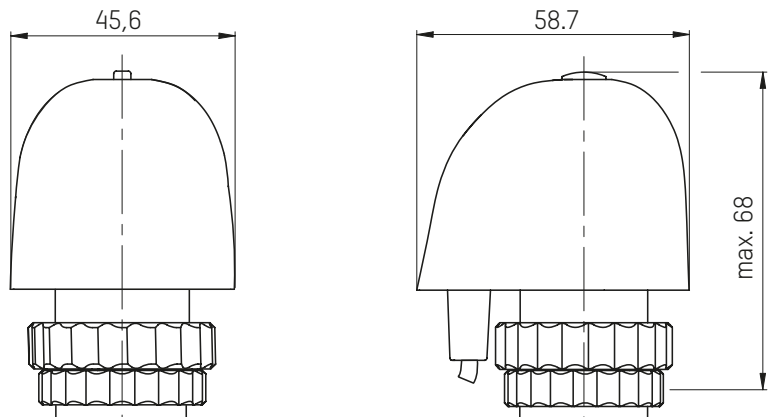

OPERATING MODES

Assembled state without current:



Type NC: Valve closed

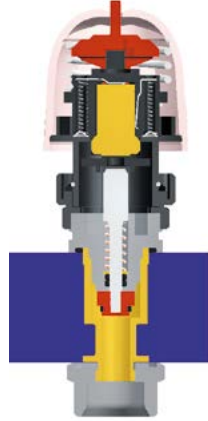

Type NO: Valve open

Operated state under current:



Type NC: Valve open



Type NO: Valve closed

CIRCUIT DIAGRAMS

Normally Closed (NC)

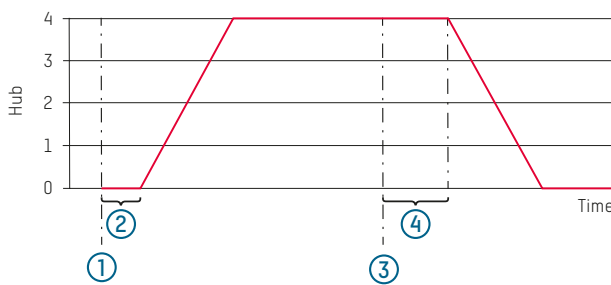

Normally Open (NO)

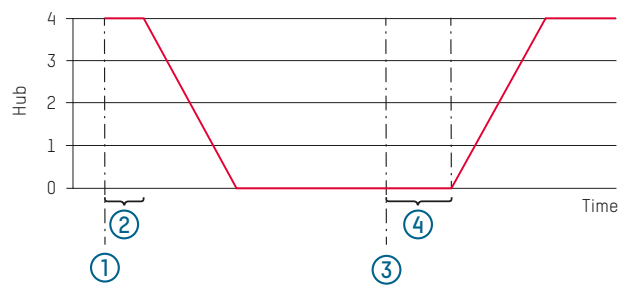

- 1 Voltage on
- 2 Dwell time on
- 3 Voltage off
- 4 Dwell time off

CONTACT AND FURTHER INFORMATION

TACONOVA.COM

Taconova Group AG | Neunbrunnenstrasse 40 | CH-8050 Zürich | T +41 44 735 55 55 | F +41 44 735 55 02 | group@taconova.com
 Taconova UK Limited | AMP Technology Centre | Brunel Way | Rotherham | S60 5WG | T +44 114 231 3700 | adminuk@taconova.com