



TB	-10 °C – 70 °C	
PB	max. 6 bar	

Klemmverschraubungen:
Anzugsmoment: max 20 Nm

Screw connections:
Locked torque: max 20 Nm

Raccordements vises :
Couple: max 20 Nm

Attachi filettati di raccordo :
Momento di serraggio: max 20 Nm

Atornilladuras de conexión :
Momento de arranque: max 20 Nm

Svěrná šroubení :
Utahovací moment: max 20 Nm

Przyłącza:
Siła dokręcenia: max 20 Nm

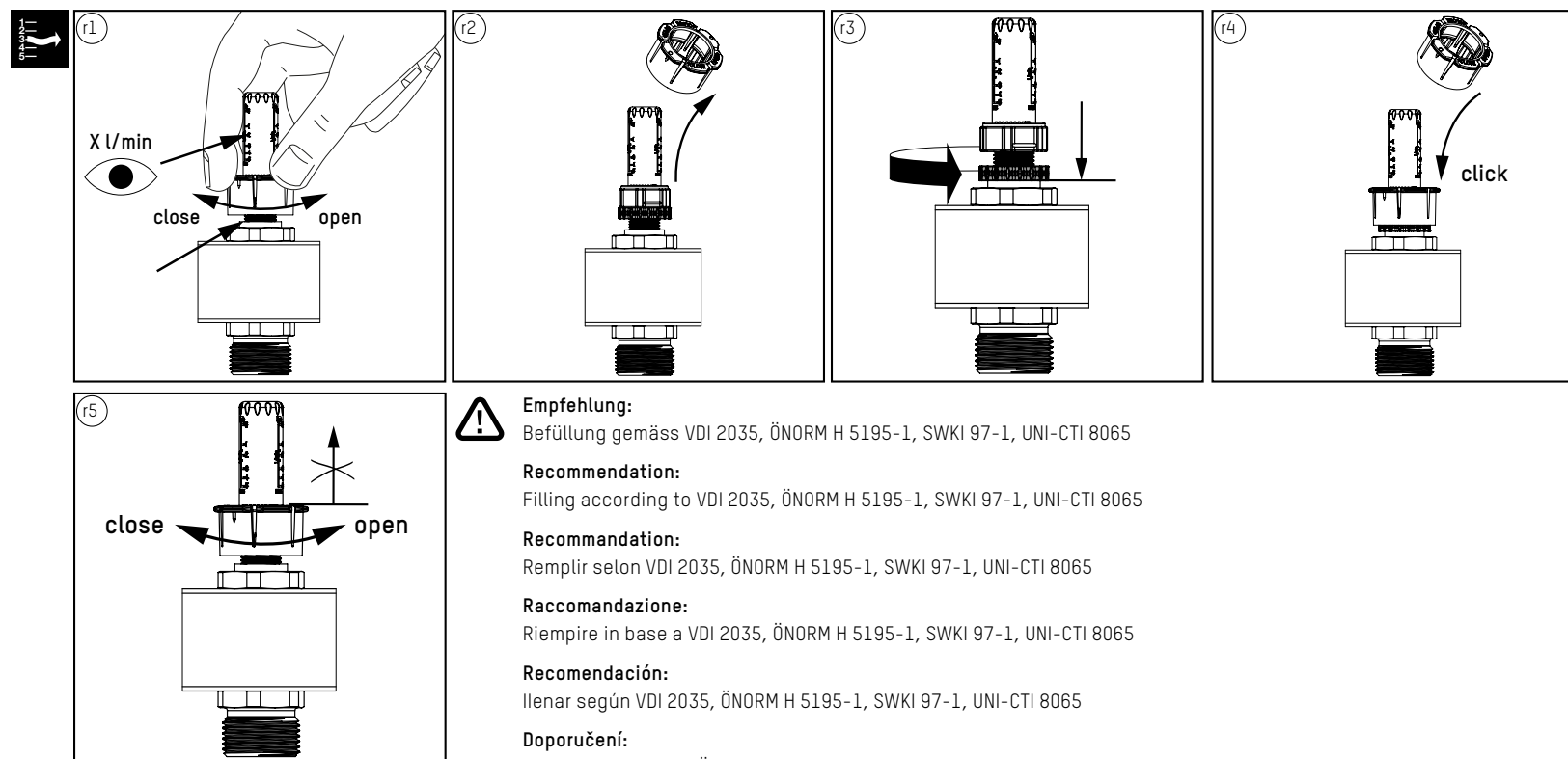

Empfehlung:
Befüllung gemäss VDI 2035, ÖNORM H 5195-1, SWKI 97-1, UNI-CTI 8065

Recommendation:
Filling according to VDI 2035, ÖNORM H 5195-1, SWKI 97-1, UNI-CTI 8065

Recommandation:
Remplir selon VDI 2035, ÖNORM H 5195-1, SWKI 97-1, UNI-CTI 8065

Raccomandazione:
Riempire in base a VDI 2035, ÖNORM H 5195-1, SWKI 97-1, UNI-CTI 8065

Recomendación:
Llenar según VDI 2035, ÖNORM H 5195-1, SWKI 97-1, UNI-CTI 8065

Doporučení:
Plnění dle VDI 2035, ÖNORM H5195-1, SWKI 97-1, UNI-CTI 8065

Zalecamy:
Napełniać zgodnie z normami VDI2035, ÖNORM H5195-1, SWKI 97-1, UNI-CTI 8065